

HIGHWAYS AND TRANSPORT COMMITTEE

A500 Dualling from Meremoor Moss Roundabout to M6 Junction 16 - to authorise the making of a Compulsory Purchase Order and Side Roads Order for delivery of the A500 Dualling scheme

Appendix C

Draft – plans referred to in The Cheshire East Council (A500 Dualling- Meremoor Moss Roundabout to M6 Junction 16) Compulsory Purchase Order 2022

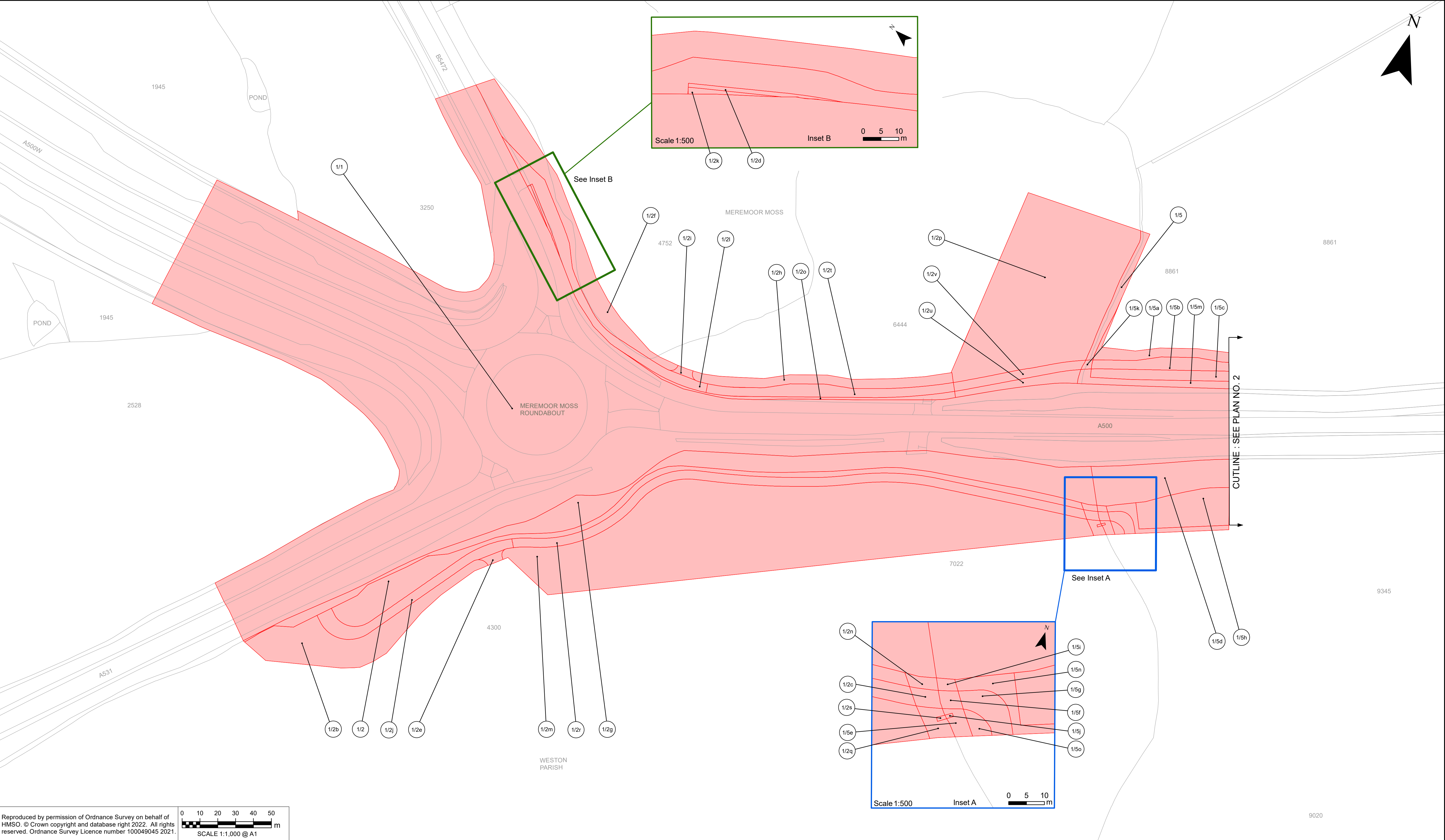

Reproduced by permission of Ordnance Survey on behalf of HMSO. © Crown copyright and database right 2022. All rights reserved. Ordnance Survey Licence number 100049045 2021.

0 10 20 30 40 50 m
SCALE 1:1,000 @ A1

- NOTES:**
- Order under sections 8, 239, 240, 246, 250 and 260 of the Highways Act 1980.
 - This plan does not show widths or construction details.

KEY

	Title
	S250 Right
	Local authority boundary
	Parish boundary
	Public right of way
0038	Ordnance Survey field numbers

The Common Seal of
CHESHIRE EAST BOROUGH COUNCIL
was hereunto affixed in the presence of

Dated this day of 2022



MAP REFERRED TO IN THE CHESHIRE EAST COUNCIL (A500 DUALLING - MEREMOOR MOSS ROUNDABOUT TO M6 JUNCTION 16)

COMPULSORY PURCHASE ORDER
PLAN 2022

MEREMOOR MOSS
ROUNDABOUT AND
OTHER ALTERATIONS
SITE PLAN NO.1

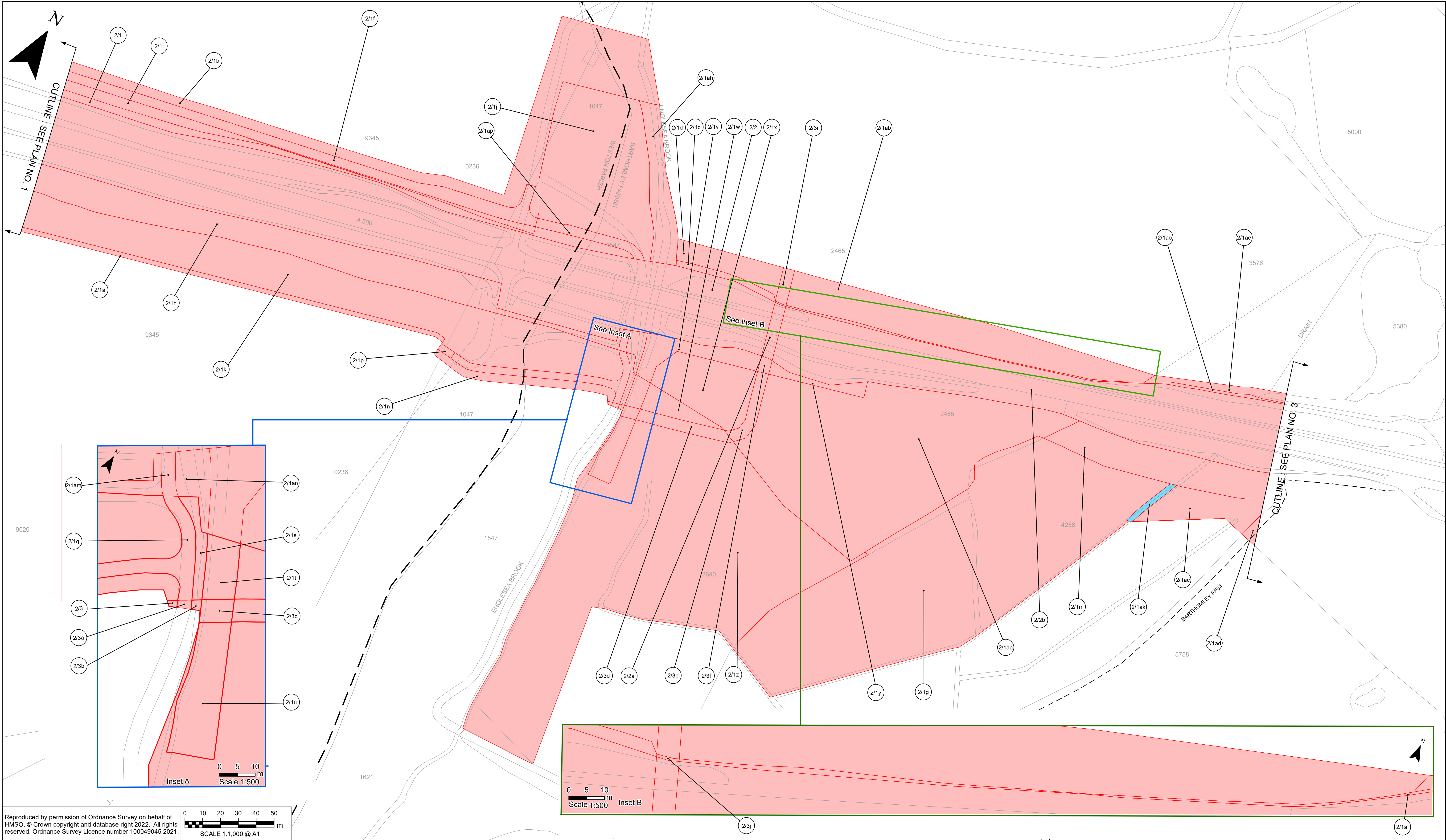

NOTES:

- Order under sections 8, 239, 240, 246, 250 and 260 of the Highways Act 1980.
- This plan does not show widths or construction details.

- KEY**
- Title
 - S250 Right
 - Local authority boundary
 - Parish boundary
 - Public right of way
 - Ordnance Survey field numbers

The Common Seal of
CHESHIRE EAST BOROUGH COUNCIL
was hereunto affixed in the presence of

Dated this day of 2022



MAP REFERRED TO IN THE CHESHIRE EAST COUNCIL (A500 DUALLING - MEREMOOR MOSS ROUNDABOUT TO M6 JUNCTION 16)

COMPULSORY PURCHASE ORDER
PLAN 2022

ENGLESEA BROOK,
THE DUCKERIES
AND OTHER ALTERATIONS
SITE PLAN NO. 2

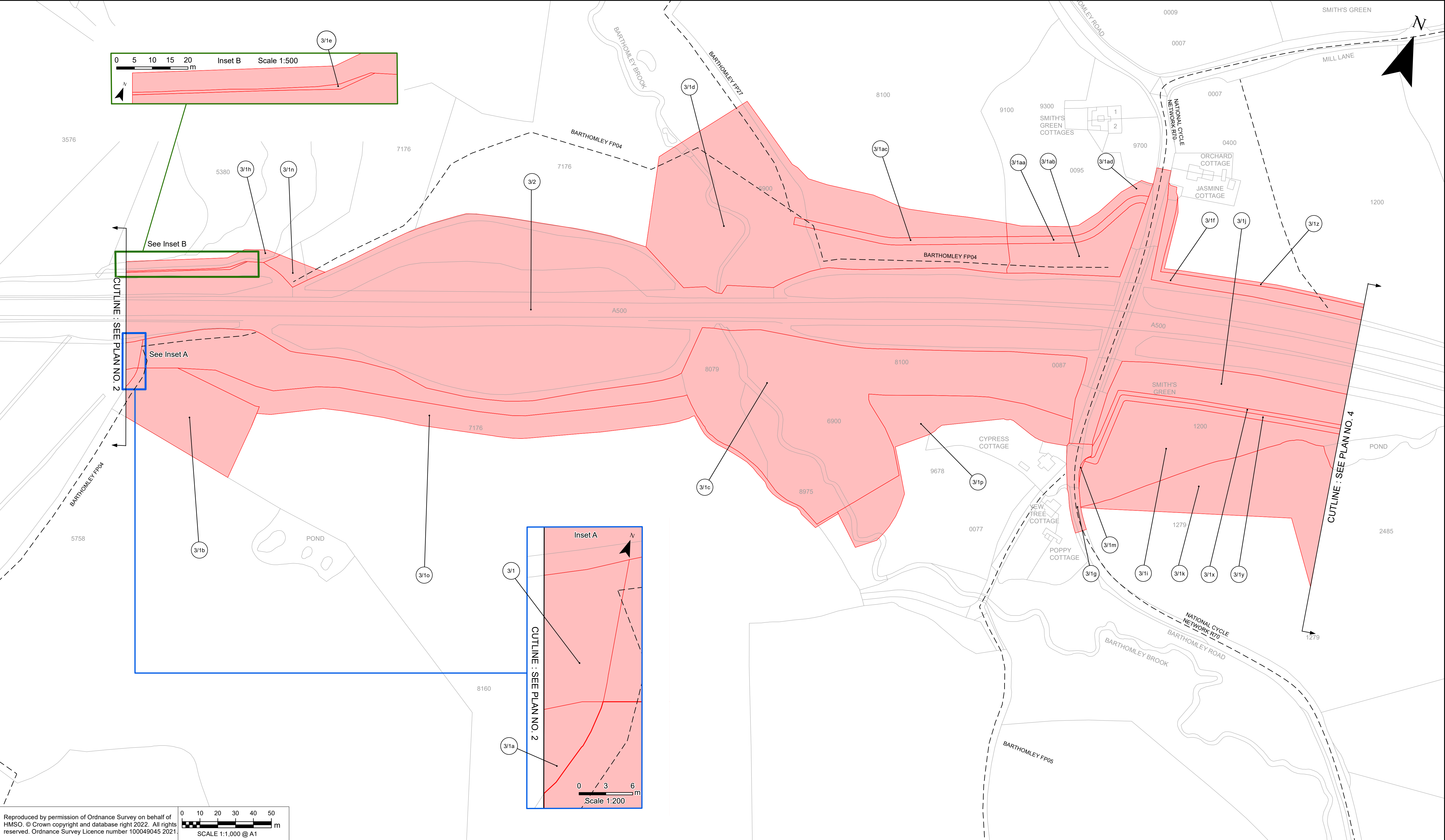

NOTES:

- Order under sections 8, 239, 240, 246, 250 and 260 of the Highways Act 1980.
- This plan does not show widths or construction details.

- KEY**
- Title
 - S250 Right
 - Local authority boundary
 - Parish boundary
 - Public right of way
 - 0038 Ordnance Survey field numbers

The Common Seal of
CHESHIRE EAST BOROUGH COUNCIL
was hereunto affixed in the presence of

Dated this day of 2022



MAP REFERRED TO IN THE CHESHIRE EAST COUNCIL (A500 DUALLING - MEREMOOR MOSS ROUNDABOUT TO M6 JUNCTION 16)

COMPULSORY PURCHASE ORDER
PLAN 2022

BARTHOMLEY BROOK,
BARTHOMLEY ROAD AND
OTHER ALTERATIONS
SITE PLAN NO. 3

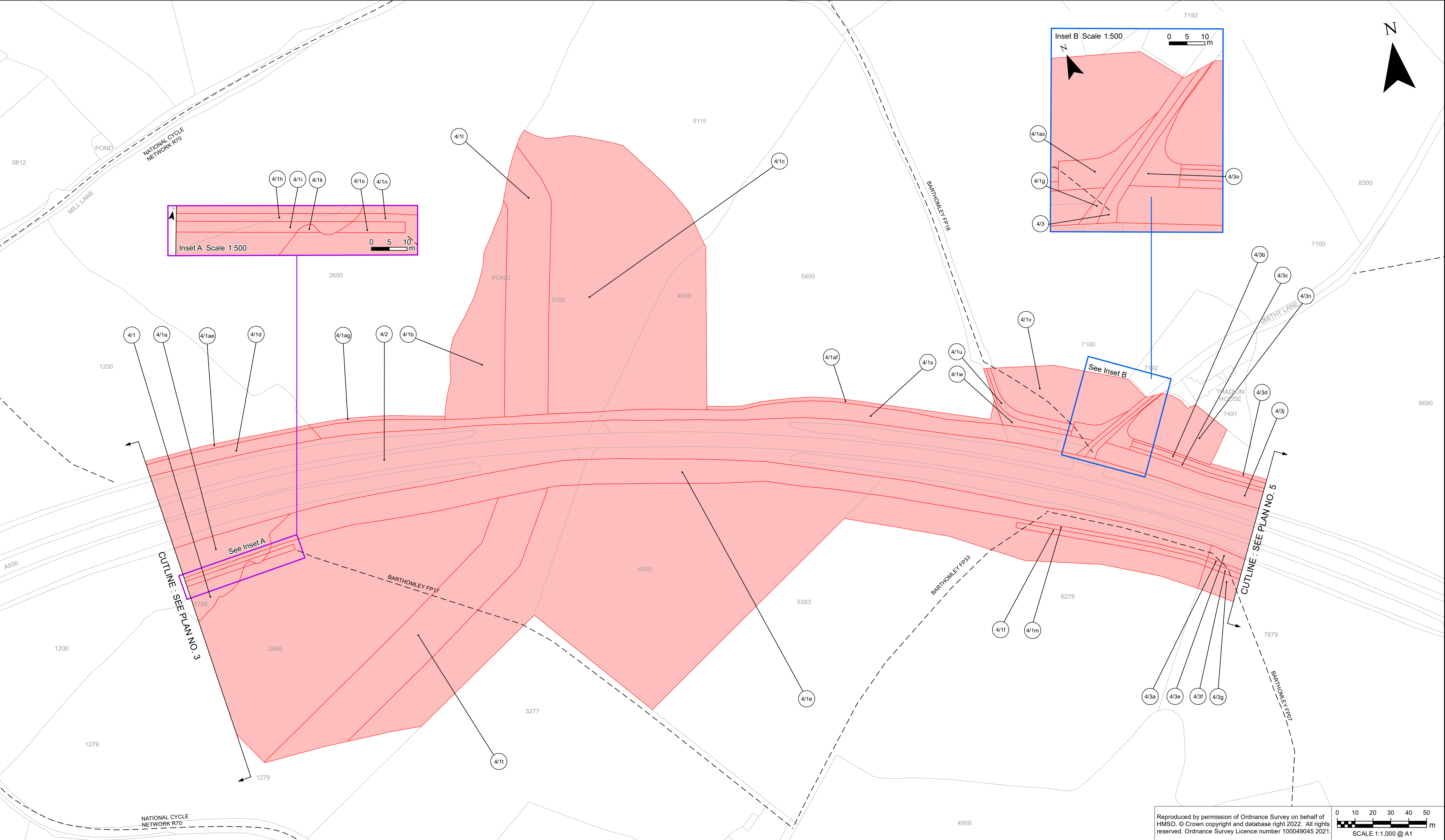

NOTES:

- Order under sections 8, 239, 240, 246, 250 and 260 of the Highways Act 1980.
- This plan does not show widths or construction details.

KEY	
<div></div>	Title
<div></div>	S250 Right
<div></div>	Local authority boundary
<div></div>	Parish boundary
<div></div>	Public right of way
0038	Ordnance Survey field numbers

The Common Seal of
CHESHIRE EAST BOROUGH COUNCIL
was hereunto affixed in the presence of

Dated this day of 2022



MAP REFERRED TO IN THE CHESHIRE EAST COUNCIL (A500 DUALLING - MEREMOOR MOSS ROUNDABOUT TO M6 JUNCTION 16)

COMPULSORY PURCHASE ORDER
PLAN 2022

LAND AT DAISY BANK FARM, SMITHY LANE AND OTHER ALTERATIONS
SITE PLAN NO. 4

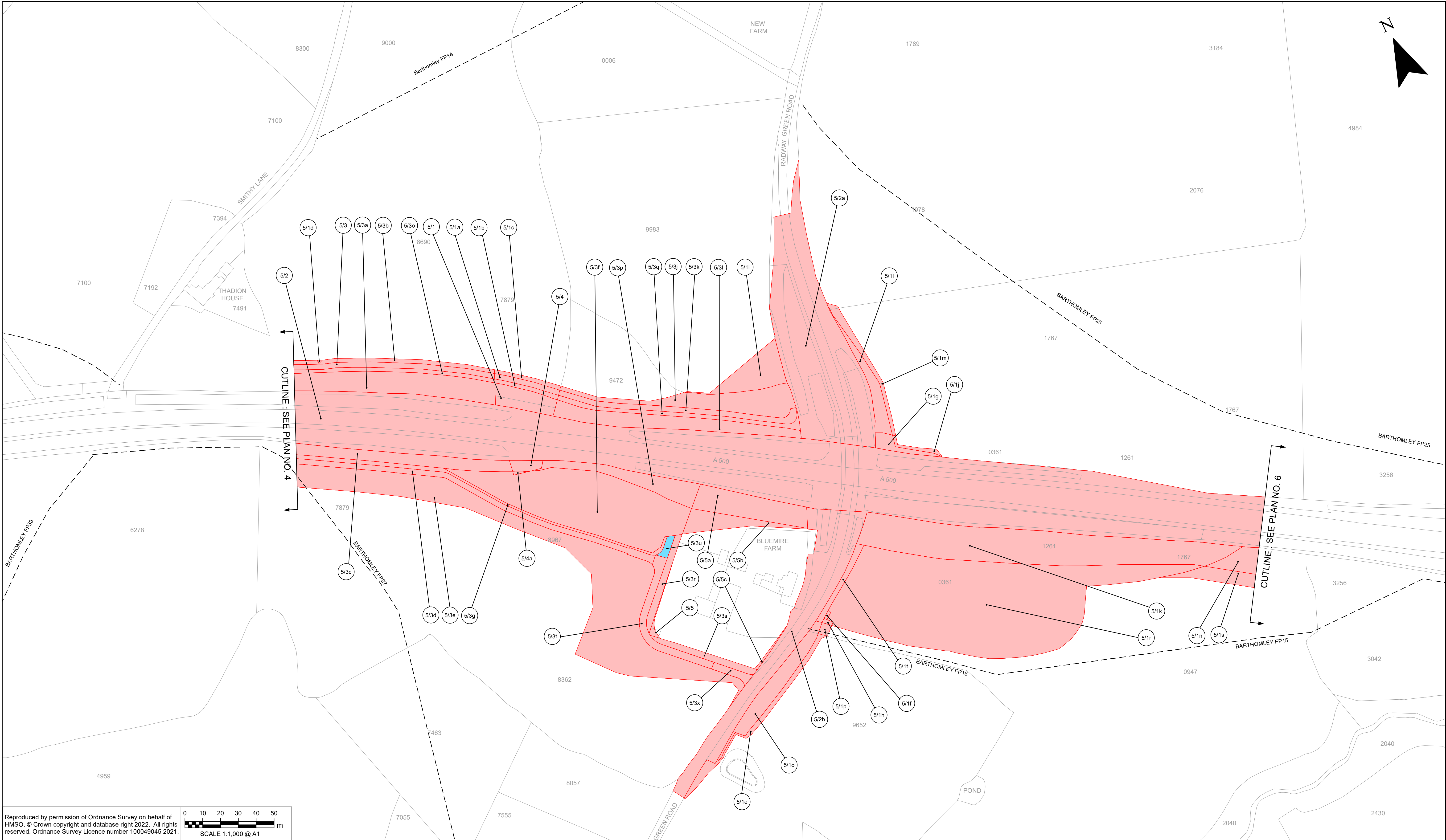

Reproduced by permission of Ordnance Survey on behalf of HMSO. © Crown copyright and database right 2022. All rights reserved. Ordnance Survey Licence number 100049045 2021.

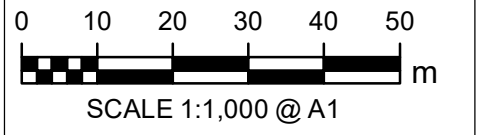

- NOTES:**
- Order under sections 8, 239, 240, 246, 250 and 260 of the Highways Act 1980.
 - This plan does not show widths or construction details.

- KEY**
- Title
 - S250 Right
 - Local authority boundary
 - Parish boundary
 - Public right of way
 - 0038 Ordnance Survey field numbers

The Common Seal of
CHESHIRE EAST BOROUGH COUNCIL
was hereunto affixed in the presence of

Dated this day of 2022



MAP REFERRED TO IN THE CHESHIRE EAST COUNCIL (A500 DUALLING - MEREMOOR MOSS ROUNDABOUT TO M6 JUNCTION 16)

COMPULSORY PURCHASE ORDER
PLAN 2022

BLUEMIRE FARM,
RADWAY GREEN ROAD
AND OTHER ALTERATIONS
SITE PLAN NO. 5

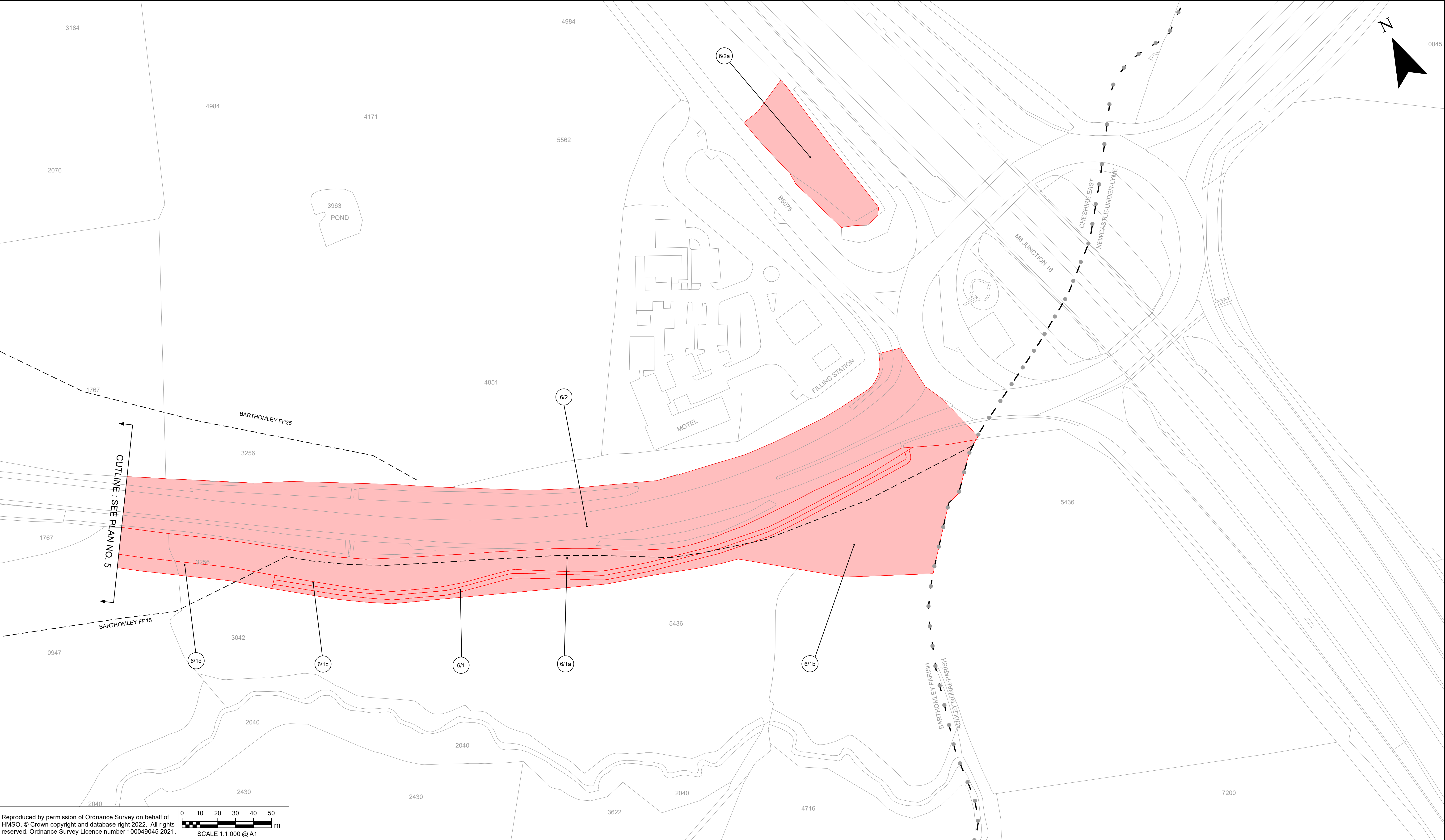

Reproduced by permission of Ordnance Survey on behalf of HMSO. © Crown copyright and database right 2022. All rights reserved. Ordnance Survey Licence number 100049045 2021.

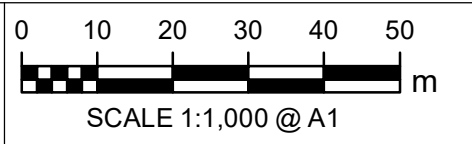

NOTES:

1. Order under sections 8, 239, 240, 246, 250 and 260 of the Highways Act 1980.
2. This plan does not show widths or construction details.

KEY

- Title
- S250 Right
- Local authority boundary
- Parish boundary
- Public right of way
- 0038 Ordnance Survey field numbers

The Common Seal of
CHESHIRE EAST BOROUGH COUNCIL
was hereunto affixed in the presence of

Dated this day of 2022



MAP REFERRED TO IN THE CHESHIRE EAST
COUNCIL (A500 DUALLING - MEREMOOR
MOSS ROUNDABOUT TO M6 JUNCTION 16)

COMPULSORY PURCHASE ORDER
PLAN 2022

M6 JUNCTION 16
ROUNDABOUT AND
OTHER ALTERATIONS
SITE PLAN NO. 6